

DASH No	THREADS PER AS8879	MS33787 ELEMENT No	A		B MIN	ID		H MAX	V MIN	J MIN
			MAX	MIN		MAX	MIN			
-4	.2500-28UNJF-3B	10	.438	.428	.408	.280	.250	.300	.030	.110
-5	.3125-24UNJF-3B	12	.531	.521	.501	.342	.312	.385	.045	.147
-6	.3750-24UNJF-3B	14	.649	.639	.609	.405	.375	.455	.070	.176
-7	.4375-20UNJF-3B	18	.750	.740	.710	.473	.438	.520	.085	.206
-8	.5000-20UNJF-3B	20	.828	.818	.788	.535	.500	.600	.105	.235
-9	.5625-18UNJF-3B	22	.938	.928	.898	.597	.562	.680	.105	.264
-10	.6250-18UNJF-3B	24	1.050	1.040	1.010	.660	.625	.740	.105	.294
-12	.7500-16UNJF-3B	30	1.230	1.220	1.190	.785	.750	.900	.130	.353
-14	.8750-14UNJF-3B	34	1.438	1.428	1.398	.910	.875	1.060	.155	.411
-16	1.0000-12UNJF-3B	38	1.625	1.615	1.575	1.035	1.000	1.210	.185	.470

DASH No	THREADS PER AS8879	MS33787 ELEMENT No	X MIN	ULTIMATE AXIAL STRENGTH LBS MIN	SEATING TORQUE IN-LBS	APPROX WEIGHT LBS/100
-4	.2500-28UNJF-3B	10	.003	8,870	130	.41
-5	.3125-24UNJF-3B	12	.003	14,100	260	.77
-6	.3750-24UNJF-3B	14	.003	20,900	460	1.20
-7	.4375-20UNJF-3B	18	.003	28,300	730	1.80
-8	.5000-20UNJF-3B	20	.003	37,800	1100	3.50
-9	.5625-18UNJF-3B	22	.004	47,900	1600	4.60
-10	.6250-18UNJF-3B	24	.004	59,900	2200	6.10
-12	.7500-16UNJF-3B	30	.004	86,900	3900	11.00
-14	.8750-14UNJF-3B	34	.005	119,000	6100	17.00
-16	1.0000-12UNJF-3B	38	.006	155,000	9200	25.00

TOLERANCE: UNLESS OTHERWISE SPECIFIED: DECIMAL ±.015 ANGLES 2° VENDOR CODE IDENT No. 27238

BRISTOL INDUSTRIES 630 EAST LAMBERT RD. BREA, CALIFORNIA 92821 (714) 990-4121

TITLE
**SPLINE-NUT, ALLOY STEEL,
 SELF-LOCKING, 220 KSI, 450°F**

PART NO.
BH14164

REVISED

TRANG N.

08-25-04

APPROVED DATE:

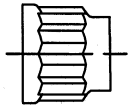
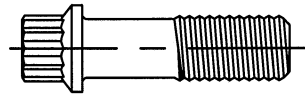

MATERIAL: ALLOY STEEL PER AMS6304 & AMS6487.

HARDNESS: 48 HRC MAX.

FINISH: CADMIUM PLATE PER MIL-C-8837, TYPE II, CLASS 2.

LUBRICANT: LUBRICANTS SHALL BE SOLUBLE IN THE CLEANER SPECIFIED IN PROCUREMENT SPECIFICATION NASM8922.

PAINT: AFTER BAKE, PAINT THE AREA ABOVE WRENCHING ELEMENT WITH No. 15102 BLUE PER TT-E-489.

PERFORMANCE: NASM8922, EXCEPT FOR:

- a) THREADS AND BEARING SURFACES SHALL BE LUBRICATED WITH MIL-T-5544 COMPOUND FOR WRENCH TORQUE, TORQUE EFFECTIVITY, LOCKING TORQUE, PERMANENT SET, ACCELERATED VIBRATION, STRESS DURABILITY & STRESS CORROSION.
- b) SEATING TORQUE FOR TORQUE EFFECTIVITY TEST AS TABULATED.
- c) MINIMUM BREAKAWAY 1st CYCLE TORQUE VALUES ARE NOT APPLICABLE. USE MINIMUM BREAKAWAY TORQUE VALUES.
- d) FOR WRENCHING TORQUE, BOLTS SHALL BE 260,000 P.S.I MINIMUM.

BRISTOL PART No.: BH14164-8 - .5000-20UNJF-3B, CADMIUM PLATED, SOLUBLE LUBRICANT.

NOTES:

- 1. SURFACE TEXTURE: BEARING SURFACE 125 MICROINCHES PER ANSI B46.1.

TOLERANCE: UNLESS OTHERWISE SPECIFIED: DECIMAL ±.015 ANGLES 2° VENDOR CODE IDENT No. 27238

BRISTOL INDUSTRIES 630 EAST LAMBERT RD. BREA, CALIFORNIA 92821 (714) 990-4121

TITLE

SPLINE-NUT, ALLOY STEEL,
 SELF-LOCKING, 220 KSI, 450°F

PART NO.

BH14164